

# ASSEMBLY INSTRUCTION FOR SCREENS UNDER 8'

## START HERE

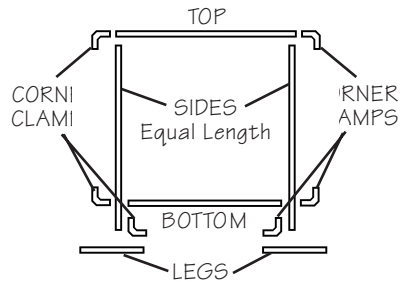

All frames up to 8' in width have 6 pieces of SQUARE TUBING and 6 CORNER CLAMPS. The two pieces of tubing that are of equal length, are the SIDES. Of the remaining pieces, the longer piece is the TOP; the shorter piece is the BOTTOM and fits inside the two side pieces. The last two pieces are the LEGS.

## STEP 1

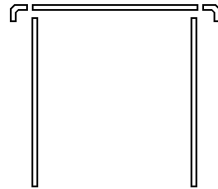

On a flat work surface, layout the 2 side pieces and top piece as shown above. Attach the corner clamps at both corners with the top piece resting on top of the side pieces (see DETAIL 1). Tighten corner clamp wing nuts.

## STEP 2

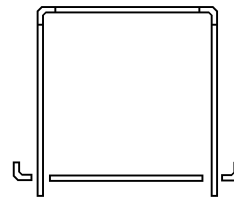

Temporarily attach the bottom piece with corner clamps as shown above. (see DETAIL 2).

## STEP 3

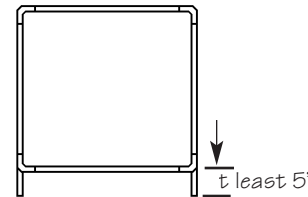

Adjust the bottom piece so it is at least 5" from the bottom of the side pieces. Tighten corner clamp wing nuts.

## STEP 4

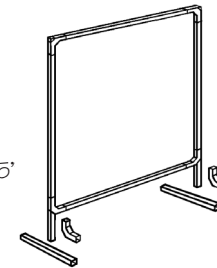

Stand the frame upright. Center the side pieces on the leg pieces and attach using the last 2 corner clamps, as shown above (see DETAIL 3). Tighten corner clamp wing nuts.

## STEP 5

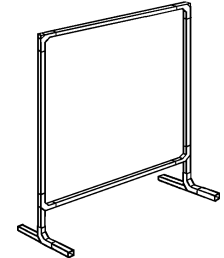

Once the frame is completed, the P.V.C. screen must be attached.

## STEP 6

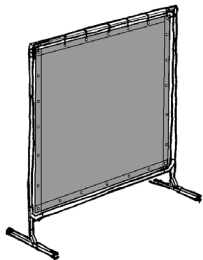

Hang the screen inside the frame. Attach the screen to the top tubing by threading the plastic cable ties (supplied) through the grommets and over the tubing (see DETAIL 4). Do the corners first, then the center and finally the remaining grommets (top tubing only).

NOTE: Do not over-tighten the cable ties. The screen should float inside the frame.

## STEP 7

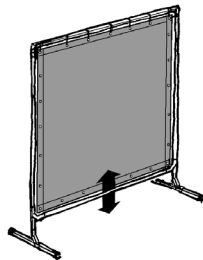

Adjust the screen left to right if necessary. Loosen the bottom corner clamps and adjust (up or down) to allow the screen to float inside the frame. Tighten corner clamp wing nuts. Next, tie-down all remaining grommets to the frame.

## STEP 8

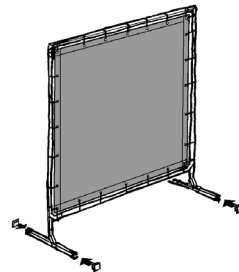

To complete the assembly, fit the plastic end-caps (supplied) over the ends of each leg.

DETAIL 1

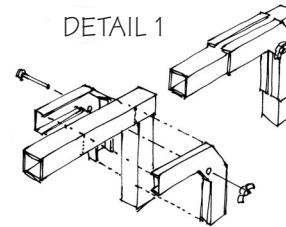

DETAIL 2

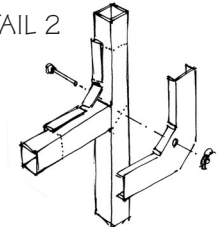

DETAIL 4

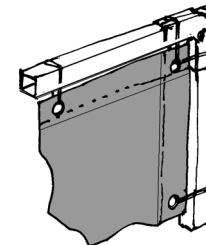

DETAIL 3

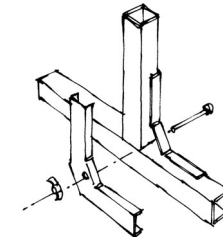

700 Vista Park Drive  
Pittsburgh, PA 15205-1214

**SAVET® SCREEN**  
**ASSEMBLY INSTRUCTIONS**

# OPTIONAL EQUIPMENT AND REPLACEMENT PARTS

## COMMON SIZE SCREENS

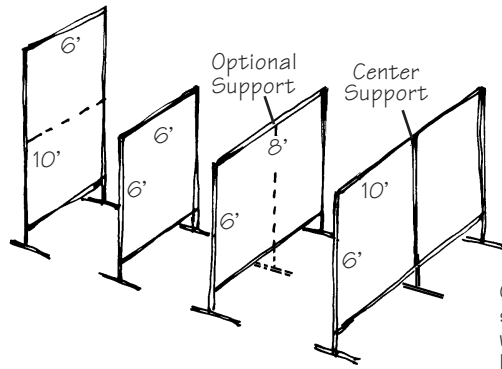

## ASSEMBLY OF CENTER SUPPORT CONSTRUCTION

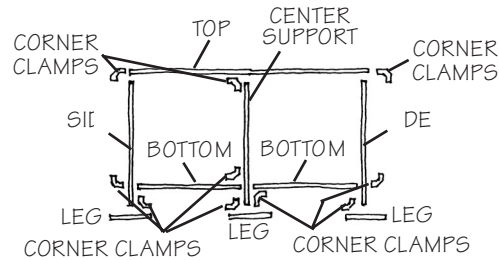

On frames wider than 8', we include an additional center support. Therefore, instead of usual 4 pieces of tubing, the wider frame will have 6 pieces. Three pieces will be of equal length. These are the 2 SIDES and CENTER SUPPORT. There will be 1 long piece for the TOP and 2 short pieces for the BOTTOM. In addition, there will be 3 LEGS. In addition there will be 10 CORNER CLAMPS

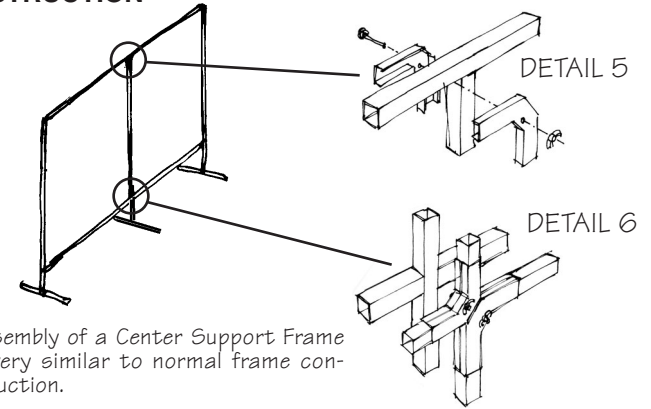

Assembly of a Center Support Frame is very similar to normal frame construction.

FIRST, attach the top tube to the 2 sides (see DETAIL 1, reverse side) and center support (see DETAIL 5). The center support should be centered on the top tube.

SECOND, attach the 2 bottom tubes to the side pieces (see DETAIL 2, reverse side) and the center support (see DETAIL 6). The bottom tubes should be at least 5" from the bottom of the side and center tubes.

THIRD, stand the frame upright and attach the 3 legs as in Step 4 (see reverse side).

FINALLY, attach the P.V.C. screen using Steps 6, 7 and 8 (see reverse side). The only difference is in Step 7, there are 2 bottom pieces to adjust, not one.

## MULTIPLE SCREENS WITH HINGED CORNER CLAMPS

Hinged corner clamps are used for multiple screen construction, as shown in the illustrations below. Note that the wing nuts are to the outside of hinge. Also, the side tubes act as legs and have plastic caps attached to the bottom of each tube.

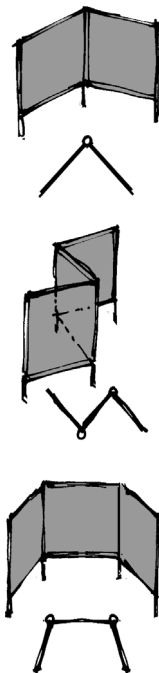
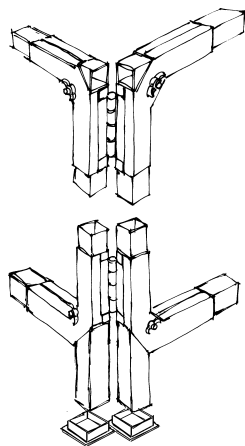

## CASTERS

Castors are primarily used for the convenience of moving single frame screens. Castors cannot be used for multiple screen construction. The stem of the caster is simply placed through the pre-drilled hole at the ends of each leg, and secured with a washer and nut. After the castors are in place, plastic end caps should be attached.

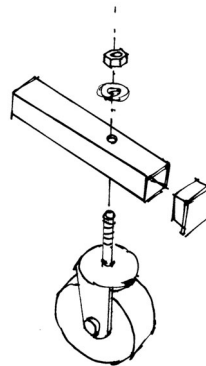

For replacement screens or curtains, measure the outside dimensions and distance between grommets on the old screen.

### Transparent Colors

- Yellow
- Orange
- Green
- Blue
- Gray

### Opaque Colors

- Yellow
- Orange
- Green
- Blue
- Red
- Brown
- Black

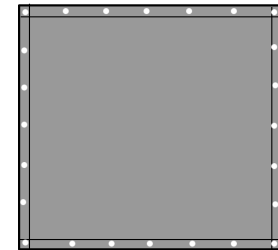

700 Vista Park Drive  
Pittsburgh, PA 15205-1214

**SAVE-T® SCREENS**  
**ASSEMBLY INSTRUCTIONS**